

FP8K-DS & FP8K-DS-XLT

Four **Post** Parking Lifts

8000 lb Capacity

Installation **&** Operation Manual



**8,000 LB.
DELUXE SERIES
STORAGE/SERVICE LIFTS**

Smooth operation and good looks make a great first impression but it's the safety features and durability that makes the "Deluxe Series" the best choice in storage/service lifts.

FP8K-DS
Deluxe Series
Storage / Service lift



Features:

- ◆ 8,000 lb. lifting capacity
- ◆ Carriages completely enclosed for safety
- ◆ Redundant ladder lock safety system with "auto engage" locking bar in the event of cable failure
- ◆ Extra large slider blocks for added stability
- ◆ 10 lock positions
- ◆ Aircraft quality cables rated at 14,500 lbs.
- ◆ 18" wide runways formed with one-piece $\frac{3}{16}$ " non-skid diamond-plate
- ◆ Easy operation: Lock release handle located near power unit
- ◆ Large 3" diameter cylinder
- ◆ Many options available



FP8K-DS-XLT
Extra length & under car clearance

SPECIFICATIONS

	FP8K-DS	FP8K-DS-XLT
Lifting capacity	8,000 lbs.	8,000 lbs.
Overall length with ramps	207 $\frac{1}{8}$ "	222 $\frac{1}{2}$ "
Overall width	103 $\frac{1}{2}$ "	109 $\frac{1}{2}$ "
Overall height	86 $\frac{1}{4}$ "	96"
Track length	165 $\frac{1}{2}$ "	180 $\frac{1}{2}$ "
Lifting height	74 $\frac{3}{4}$ "	82 $\frac{1}{4}$ "
Width between posts	94 $\frac{1}{2}$ "	100 $\frac{5}{16}$ "
Maximum clearance under tracks	70"	77 $\frac{15}{16}$ "
Shipping weight	1,640 lbs.	1,700 lbs.



Internal ladder locking system

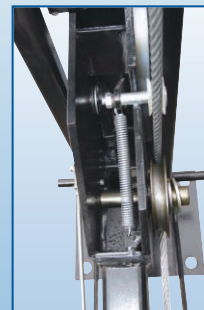

Cable safety system

TUXEDO DISTRIBUTORS LIMITED WARRANTY

Structural Warranty:

The following parts and structural components carry a five year warranty:

Columns	Top Rail Beam	Uprights	Arms Swivel Pins
Legs	Carriages	Tracks Overhead Beam	Cross Rails

Limited One-Year Warranty:

Tuxedo Distributors, LLC ("Tuxedo") offers a limited one-year warranty to the original purchaser of Tuxedo lifts and Wheel Service in the United States and Canada. Tuxedo will replace, without charge, any part found defective in materials or workmanship under normal use, for a period of one year after purchase. The purchaser is responsible for all shipping charges. This warranty does not apply to equipment that has been improperly installed or altered or that has not been operated or maintained according to specifications.

Other Limitations:

This warranty does not cover:

1. Parts needed for normal maintenance
2. Wear parts, including but not limited to cables, slider blocks, chains, rubber pads and pulleys
3. Replacement of lift and tire changer cylinders after the first 30 days. A seal kit and installation instructions will be sent for repairs thereafter.
4. On-site labor

Upon receipt, the customer must visually inspect the equipment for any potential freight damage before signing clear on the shipping receipt. Freight damage is not considered a warranty issue and therefore must be noted for any potential recovery with the shipping company.

The customer is required to notify Tuxedo of any missing parts within 72 hours. Timely notification must be received to be covered under warranty.

Tuxedo will replace any defective part under warranty at no charge as soon as such parts become available from the manufacturer. No guarantee is given as to the immediate availability of replacement parts.

Tuxedo reserves the right to make improvements and/or design changes to its lifts without any obligation to previously sold, assembled or fabricated equipment.

There is no other express warranty on the Tuxedo lifts and this warranty is exclusive of and in lieu of all other warranties, expressed or implied, including all warranties of merchantability and fitness for a particular purpose.

To the fullest extent allowed by law, Tuxedo shall not be liable for loss of use, cost of cover, lost profits, inconvenience, lost time, commercial loss or other incidental or consequential damages.

This Limited Warranty is granted to the original purchaser only and is not transferable or assignable.

Some states do not allow exclusion or limitation of consequential damages or how long an implied warranty lasts, so the above limitations and exclusions may not apply. This warranty gives you specific legal rights and you may have other rights, which may vary from state to state.

PREFACE

Prior to the operation of your lift make sure that you read the instructions thoroughly. These instructions are found in this manual. Please note that your warranty may be voided if you do not read the manual and understand its content.

IMPORTANT SAFETY INSTRUCTIONS

Read these safety instructions entirely!

Failure to read these instructions may result in injury to user, other people within the area of the lift, or vehicles. The manufacturer is not responsible for any injury or damage as a result of neglecting to carefully read and follow these instructions.

Always lock the lift in place before going under the vehicle. Never allow anyone to go under the lift when raising or lowering.

INSPECT your lift daily. Never operate if it malfunctions or if it has broken or damaged parts. Repairs should be made with original equipment parts.

ATTENTION! LOOK OUT!

Routine check of safety latch system is very important -the discovery of device failure before needed could save you from expensive property damage, lost time, serious personal injury or even death.

- **NEVER overload your lift. Manufacturer's rated capacity is shown on nameplate affixed to the lift. ALWAYS operate the lift with gross weight less than the capacity.**
- **NEVER use the lift to raise one end or one side of the vehicle.**
- **NEVER raise vehicle with anyone inside. No one should be in the lift area during operation.**
- **ALWAYS keep lift area free of obstructions, grease, oil, trash and other debris. Before lowering the lift, be sure tool trays, stands, etc. are removed from under the vehicle. Release locking devices before attempting to lower the lift.**
- **Adequate ventilation should be provided when working on internal combustion engines.**
- **Use only manufacturer's recommended attachments.**
- **KEEP HANDS and FEET CLEAR. Remove hands and feet from any moving parts. Keep feet clear of the lift when lowering. Avoid pinch points.**
- **GUARD AGAINST ELECTRIC SHOCK. This lift must be grounded while in use to protect the operator from electric shock. Never connect the yellow/green wire in the power supply cord to a line terminal. This is for ground only.**
- **DANGER! The power unit used on this lift contains high voltage.**
- **Disconnect power at the receptacle before performing any electrical repairs. Secure plug so that it cannot be accidentally plugged in during service.**
- **WARNING! RISK OF EXPLOSION. This equipment has internal arcing or sparking parts which should not be exposed to flammable vapors. This machine should not be located in a recessed area or below floor level.**

- **MAINTAIN WITH CARE.** Keep lift clean for better and safe performance. Follow instructions in the manual for proper lubrication and maintenance. Keep control handles and/or buttons dry, clean and free from grease and oil.
- **STAY ALERT.** Watch what you are doing. Use common sense. Be aware. **CHECK FOR DAMAGED PARTS.** Check for alignment of moving parts, breakage of parts or any condition that may affect its operation. Do not use lift if any component is broken or damaged
- **NEVER** remove safety related components from the lift. Do not use lift if safety related components are damaged or missing.
- **ALWAYS** wear safety glasses. Every day eyeglasses only have impact resistant lenses. They are not safety glasses.

READ AND UNDERSTAND ALL SAFETY WARNINGS & PROCEDURES BEFORE OPERATING LIFT. POST THESE SAFETY TIPS WHERE THEY WILL BE A CONSTANT REMINDER TO YOUR LIFT OPERATOR. FOR INFORMATION SPECIFIC TO THE LIFT, ALWAYS REFER TO THE LIFT MANUFACTURER'S MANUAL.

SIZE DRAWING

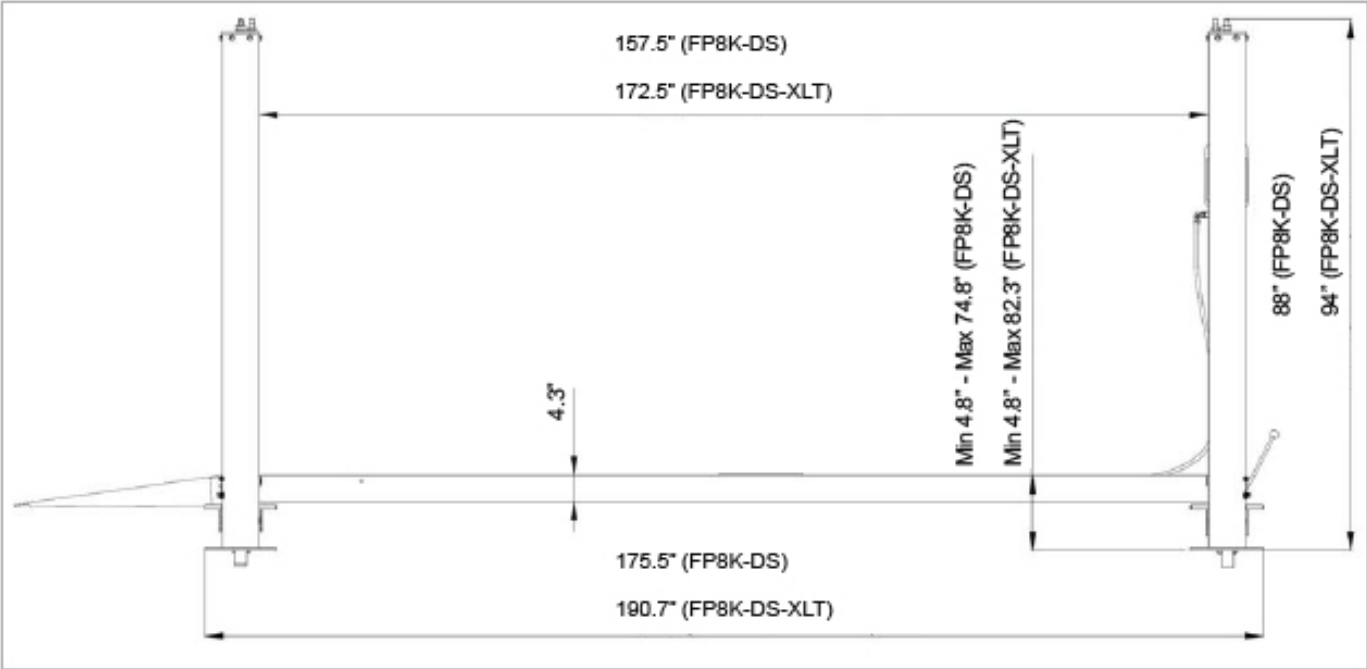

Fig. 1

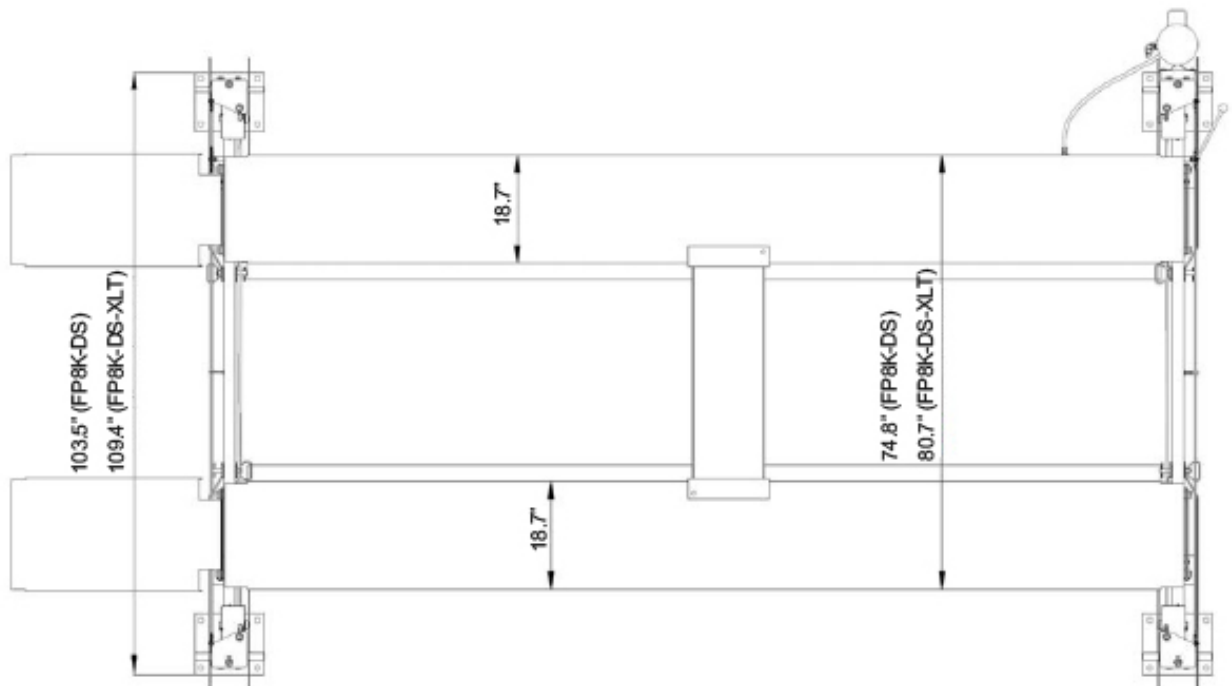

Fig. 2

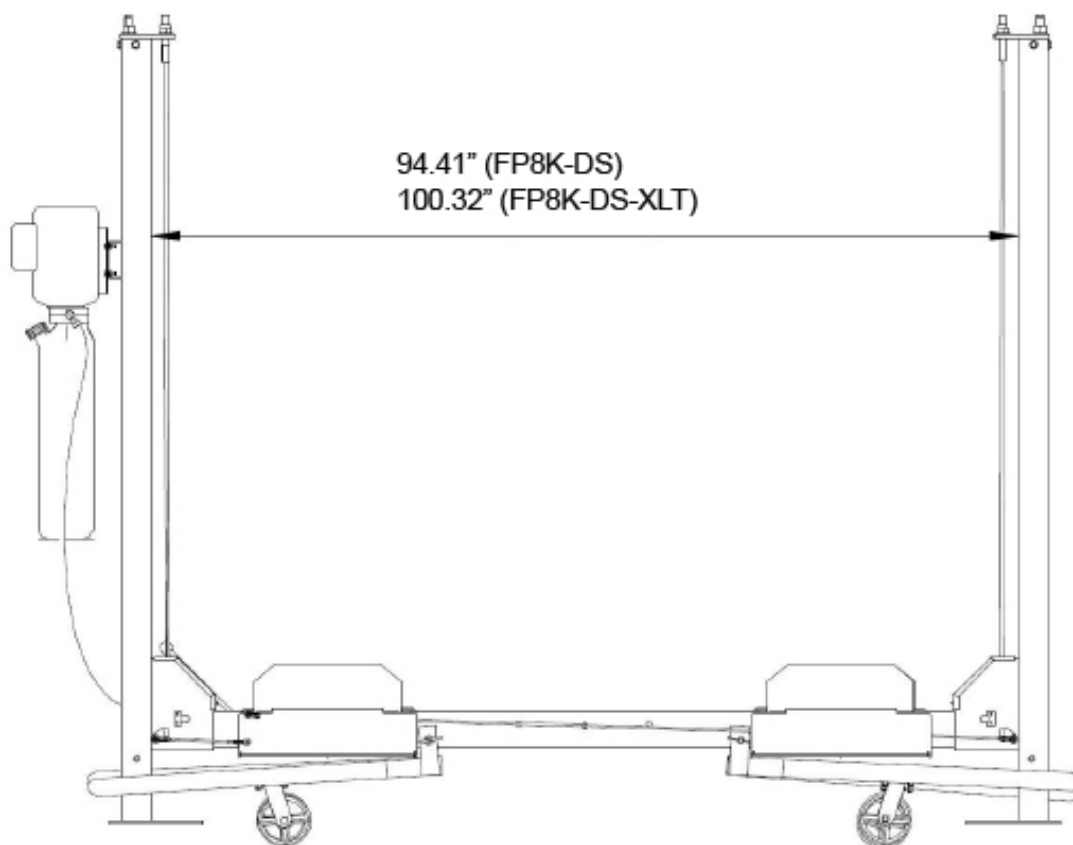

Fig. 3

SPECIFICATION:

Specifications	163016/FP8K-DS	163018/FP8K-XLT
Overall Width	2630mm(103.54")	2780mm(109.45")
Inside Columns	2398mm(94.41")	2548mm(100.32")
Width of Outside runway	1900mm(74.80")	2050mm(80.71")
Width of runway	474mm(18.66")	474mm(18.66")
Overall Length	4460mm(175.59")	4845mm(190.75")
Lifting Height	Min122~max1900mm (Min4.8"~Max 74.80")	Min122~Max2090mm (Min4.8"~Max82.28")
Overall Height	2237mm(88.07")	2390mm(94.09")
Length of Columns	4000mm(157.48")	4385mm(172.64")
Lifting Capacity	8000lbs	8000lbs
Net (Gross) Weight	745(770)kg	795(820)kg

INSTALLATION

Improper installation can cause accelerated wear, resulting in catastrophic failure which may cause property damage and / or bodily injury. Manufacturer will assume no liability for loss or damage of any kind, expressed or implied, resulting from improper installation or use of this product. Read this installation manual in its entirety before attempting to install or operate the lift.

STEP 1 SELECTING SITE

Before installing your new lift, check the following.

- **OVERHEAD OBSTRUCTIONS:** The area where the lift will be located should be free of overhead obstructions such as heaters, building supports, electrical lines etc.
- **FLOOR REQUIREMENTS:** Visually inspect the site where the lift is to be installed and check for cracked or defective concrete. This lift must be installed on a solid level concrete floor with no more than 2 degrees of slope. A level floor is suggested for proper installation and level lifting. If a floor is of questionable slope, consider a survey of the site and/or the possibility of pouring a new level concrete slab. This lift is designed to be installed on a minimum of 4" thick, 3500psi, steel reinforced concrete. Do not install this lift on asphalt, wood, or any other surface other than described. This lift is only as strong as the foundation on which it is installed.
- **DO NOT** install this lift outdoors unless special consideration has been made to protect the power unit from weather conditions. **The Power unit is not water proof!!!**
- **DO NOT** install lift close to wall. It is necessary to leave adequate clearance for safety walking. Suggest clearance be 1 meter (3 feet) at min.

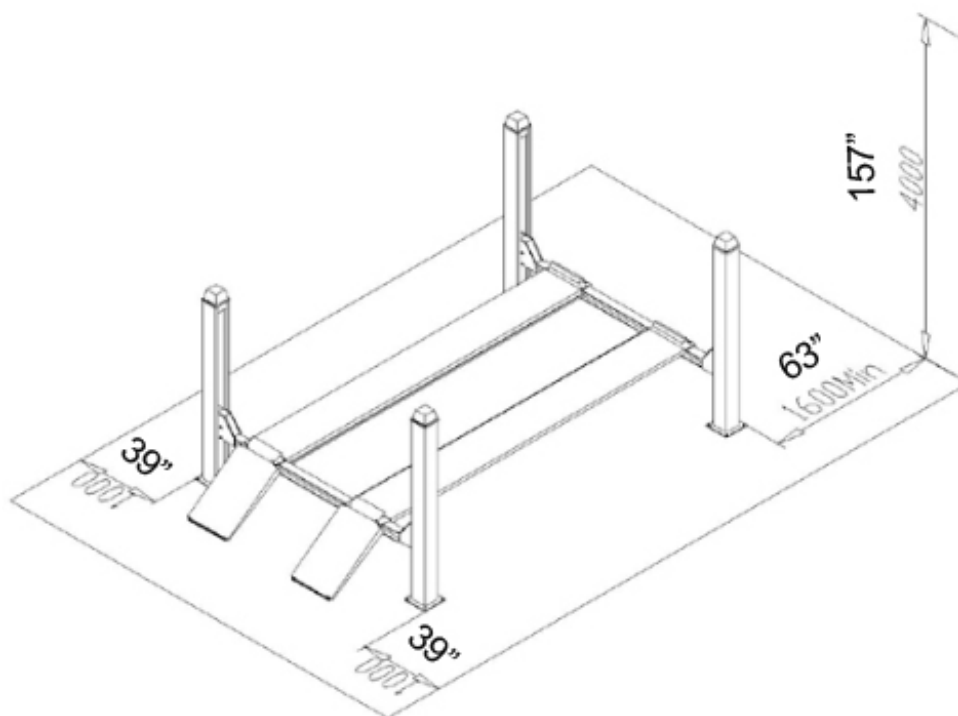

Fig.4

STEP 2 **UNPACKING**

Unpack the lift close to the installation site. Review your packing list and assembly drawing to verify that you have all the parts. Layout a chalk line on the floor for the position of columns..

TOOLS recommended

"Rotary Hammer Drill Or Similar (If anchoring)

Medium Crescent Wrench

3/4" Masonry Bit (If anchoring)

Medium Pipe Wrench

Hammer

Crow Bar

4 Foot Level

Chalk Line

Open-End Wrench Set: 12-28

Medium Flat Screwdriver

Socket And Ratchet Set: 12 -28

Tape Measure

Hex-Key / Allen Wrench Set

Needle Nose Pliers

STEP 3 **COLUMN & CROSSRAIL INSTALLATION**

- Put the columns in their respective positions. Main column (Fig.6) must be in the front-left position (Fig. 5)

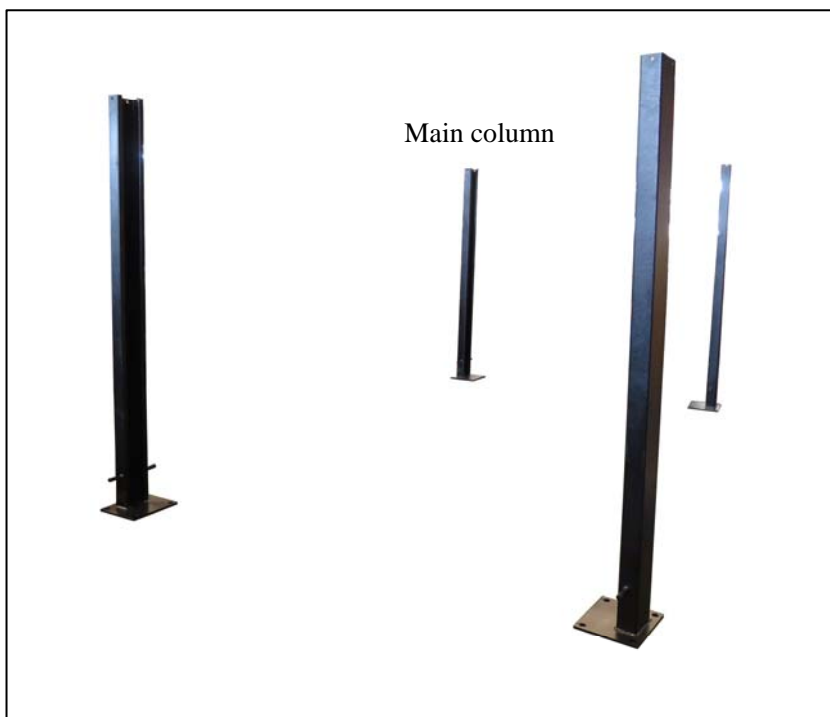

Fig.5



Fig. 6

- Insert the cross rail into the top of the left and right columns.(Fig. 7) Till it touches the ground. (Fig. 9-10)

Note: The side with the hole for the safety latch release bar must be facing out. (Fig. 8)



Fig. 7 (cross rail is facing center)



Fig. 8 Cross rail (side for facing out)



Fig. 9



Fig. 10

- Insert the safety latch ladder into the column and the end of cross rail. (Fig. 11) and raise the cross rail about one foot to rest on lowest locking position.

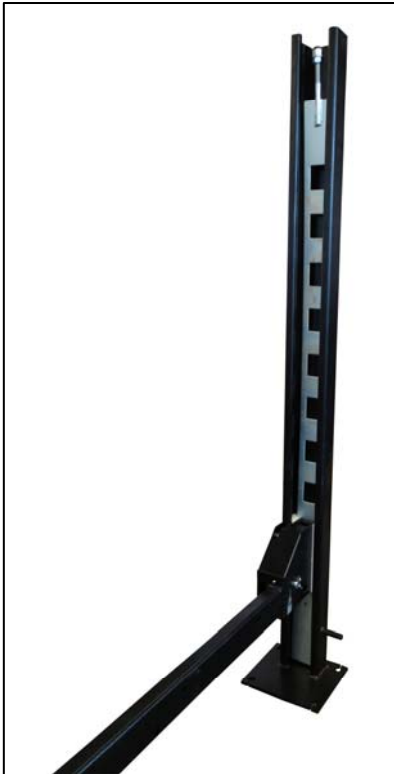

Fig. 11



Fig. 12

- Put on the column top cover then bolt it to the column. Be sure that the hole for the cable points towards the center (Fig. 12).



Fig. 13

STEP 4 CABLES

- Pull out the piston rod from the cylinder as far as possible.
- Line the cables according to the drawing (Fig. 16-17).



Fig. 14



Fig.15



Fig. 16



Fig.17

STEP 5 Platform installation

- Put the main platform (the one with cylinder) on the cross rails on the left. (Fig. 18)
- Put the sub platform on the cross rails on the right.(Fig. 19-21)
- Using bolts, fix the platforms on the cross rail temporarily.



Fig. 18



Fig. 19-21

- Let the cable go through the cross rail end then bolt to top of column. (Fig. 17-20)



Fig. 19



Fig. 20

STEP 6 Safety Latch Linkage Installation

- Install the safety latch linkage rod and other accessories on the front and rear crossbeam. (Fig 21-22)
Note: the release handle shall be on the front left near the main column.



Fig. 21



Fig. 22

- Connect the front latch and the rear latch by rods and spacer sleeve underneath the main platform. (Fig. 23)
- Fix the plat forms by bolts and accessories. (Fig. 24)
- Insert the front stop plat in the slots.



Fig. 23



Fig. 24

STEP 7 Motor pump and hydraulic hose

- Mount the motor pump on the main column.
- Connect the hose from pump to the cylinder.(Fig. 25)
- Add hydraulic oil to the pump tank.
Suggestion: using **AW-32** or **ISO-32** hydraulic oil, approximately 10L.
- Hook up the power supply to the motor pump.
Attention: Ask a qualified electrician to do the wiring.
For 220V single phase motor pump, the capacity of the power supply cable least must be at 30A. For 110V single phase motor must be at least 50A.



Fig. 25

STEP 8 TESTING

- Press the UP button on the motor to raise up the platforms.
- With left hand hold down the safety latch handle to open the lock, with right hand hold down the release handle to lower the platforms.
Note: if the latch handle is hard to hold down, raise the platforms to release the lock.
- Cycle the lift several times UP and DOWN (Stop for 1 minute intervals), if no leakage or error occurs, the lift is ready.

STEP 9 ACCESSORY MOUNTING

- Put on the ramp, tool tray and the movable dolly.(Fig. 26-27)
- If the lift won't move, take away the movable dolly. Then anchor the lift to the ground.



Fig. 26



Fig. 27

- Put the plastic sheet under the platforms. (Fig. 28)

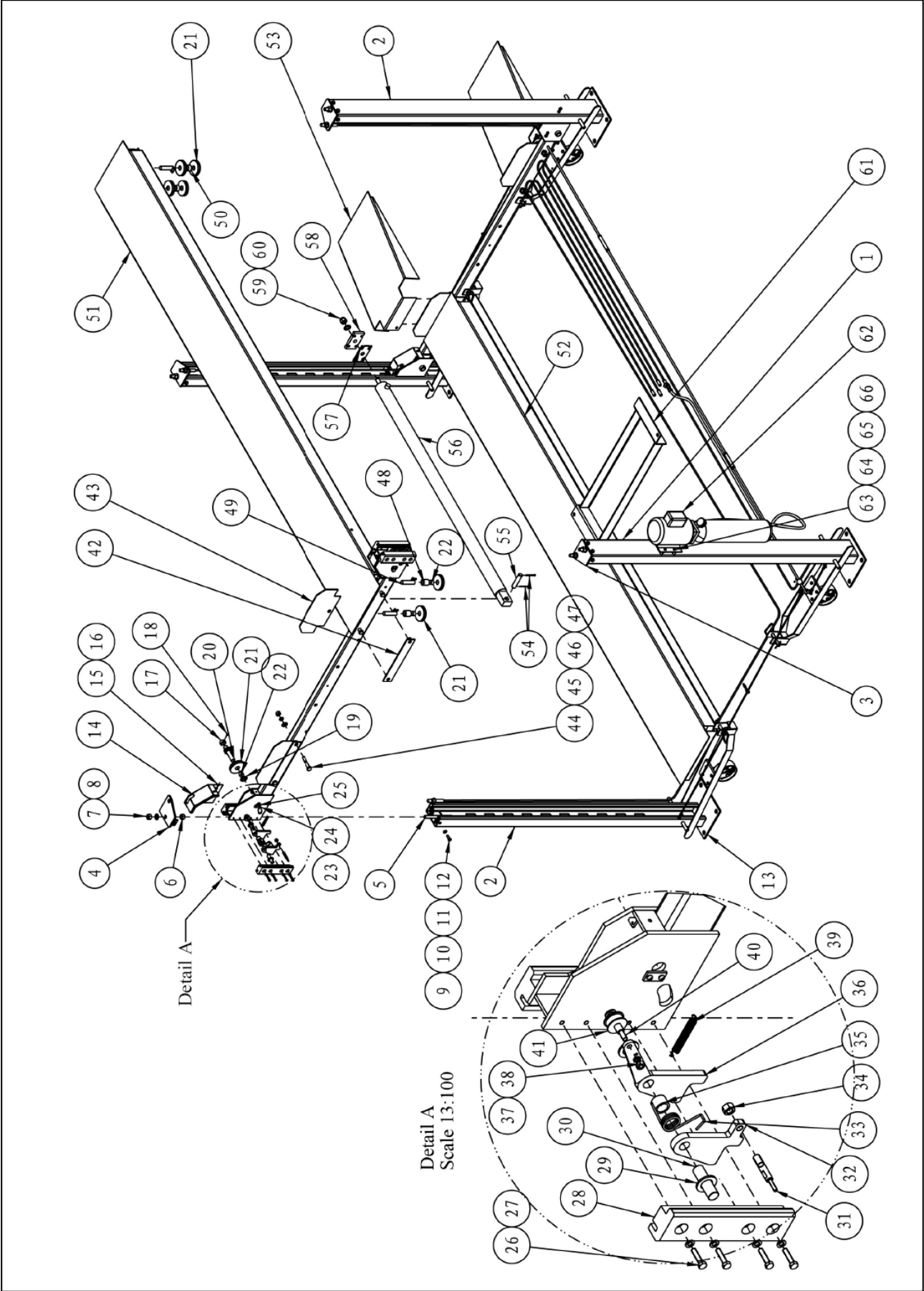

Fig. 28

Now the parking lift is ready for use.



FP8K-DS/XLT PARTS CODE AND PARTS DRAWING



FP8K-DS/XLT PARTS CODE AND PARTS DRAWING

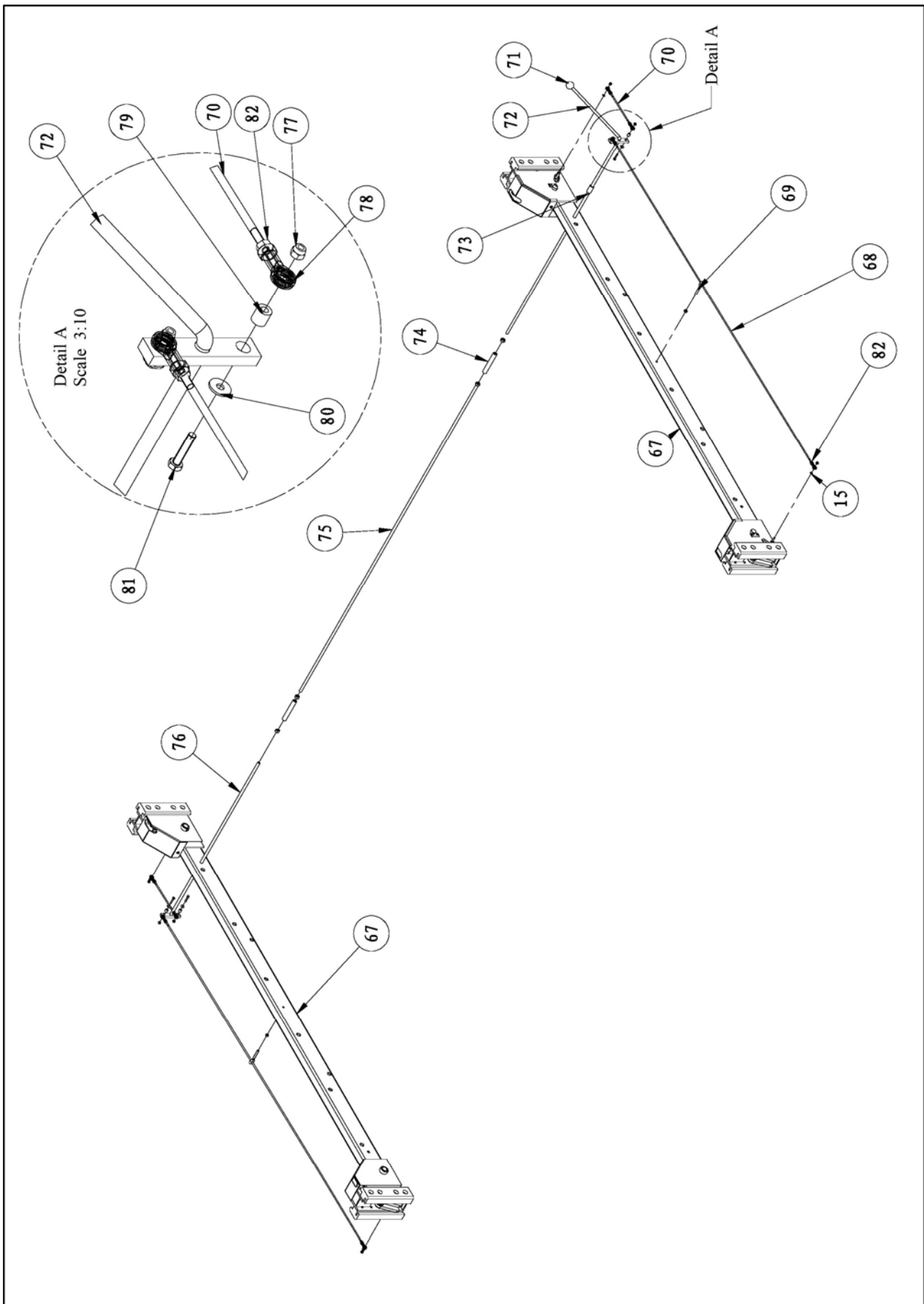

FP8K-DS/XLT PARTS CODE AND PARTS DRAWING

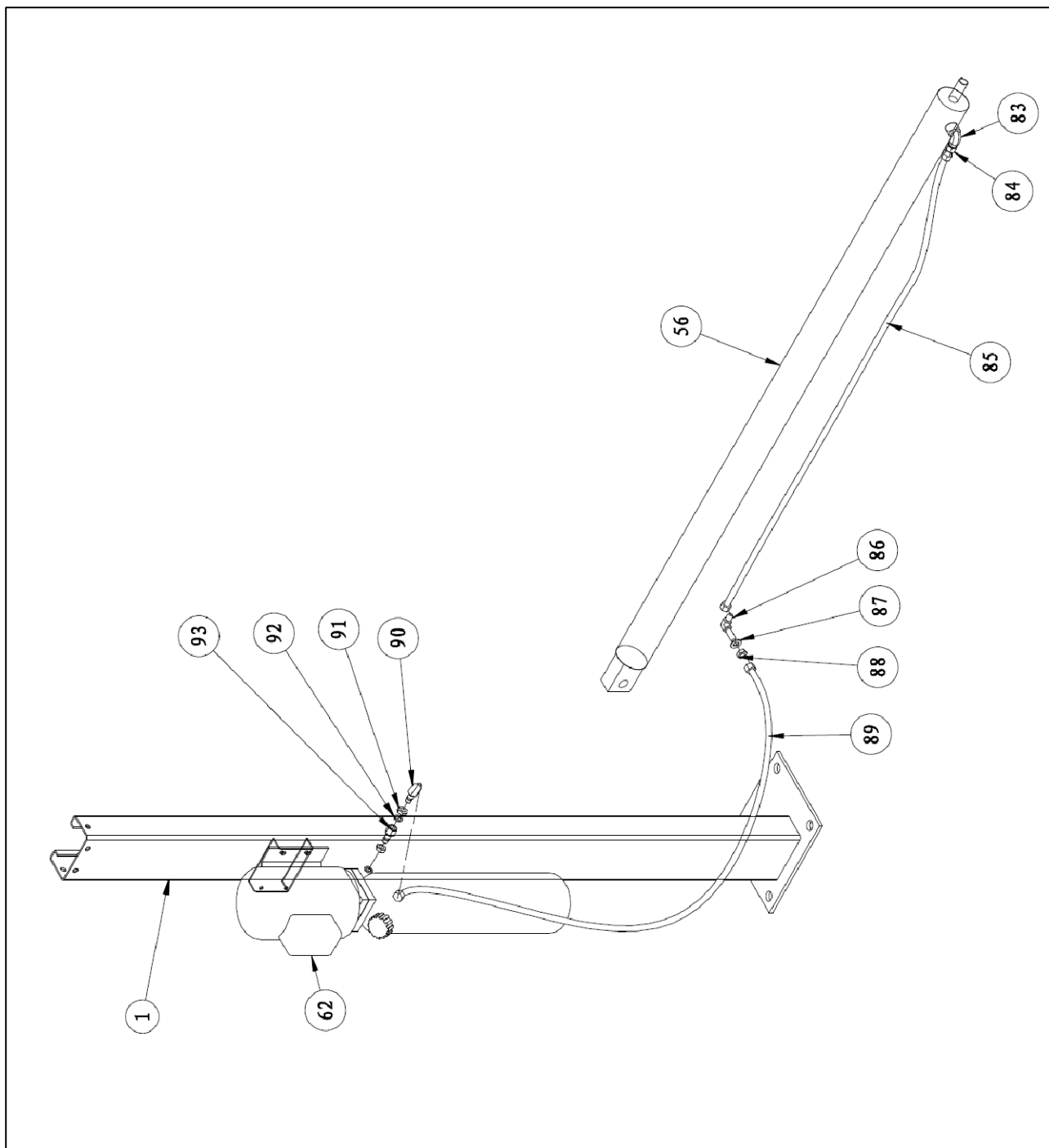

FP8K-DS/XLT PARTS CODE AND PARTS DRAWING

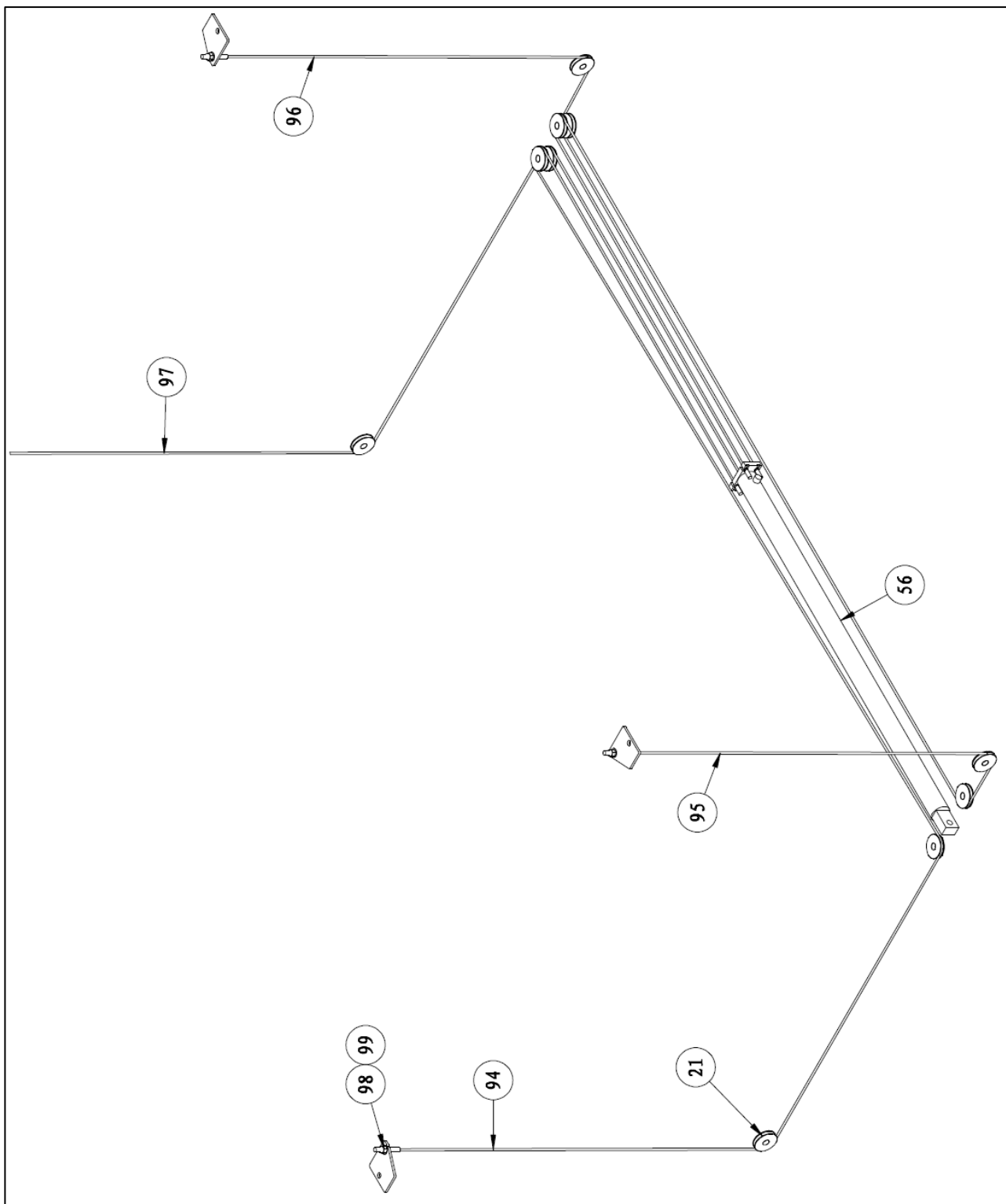

FP8K-DS/XLT PARTS CODE AND PARTS DRAWING

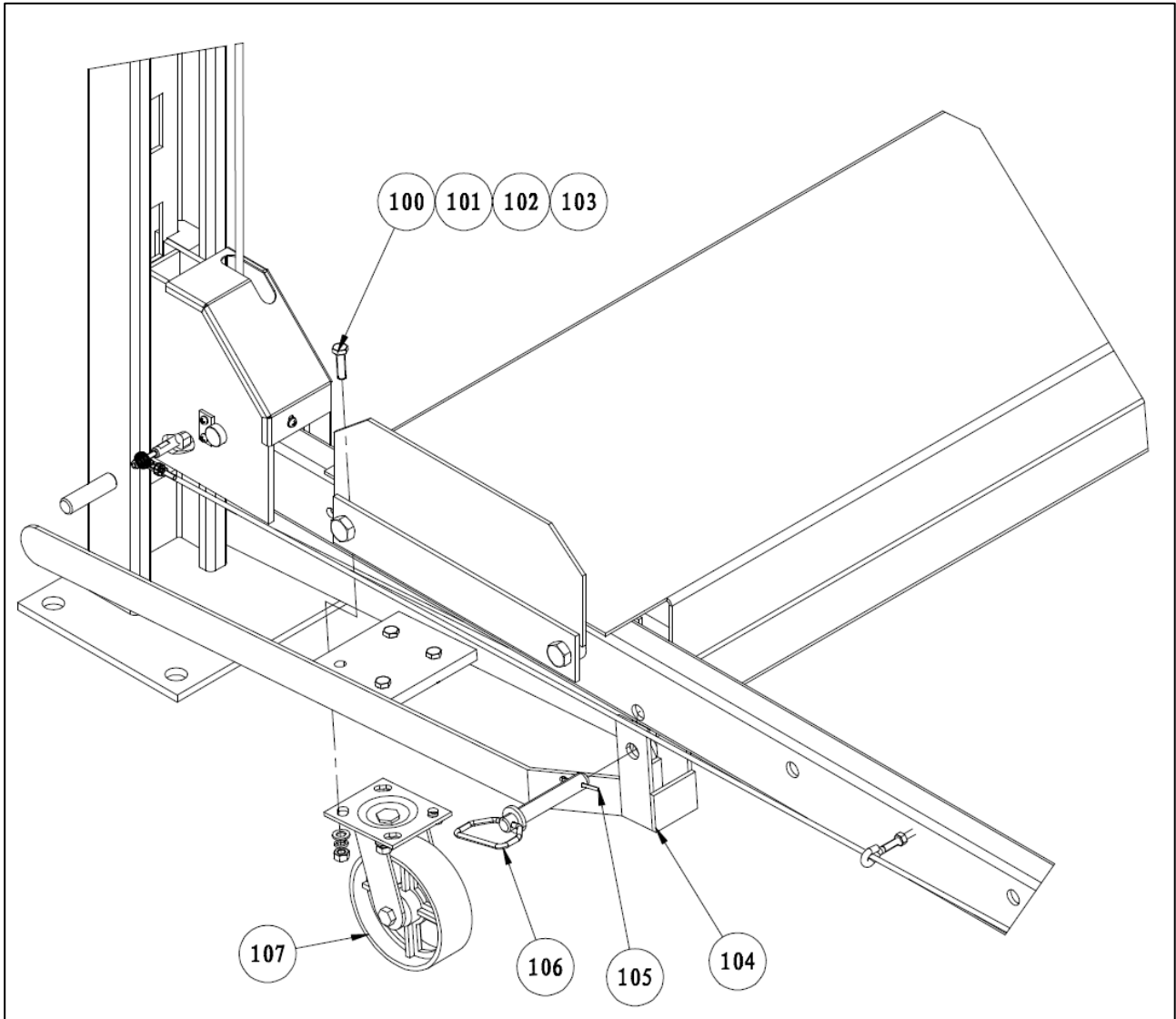

Parts code for FP8K-DS

ITEM	CODE	DESCRIPTION	QTY	NOTE
1	TT7B-100-01-00	Main column weldment	1	weldment
2	TT7B-100-02-00	Sub column weldment	3	weldment
3	TT7B-100-04-00	Top plate weldment 1	2	weldment
4	TT7B-100-03-00	Top plate weldment 2	2	weldment
5	TT7B-100-05-00	Latch ladder weldment	4	weldment
6	GB41	Hex nut	4	M20
7	GB6175	Hex nut	4	M20
8	GB95	Flat washer	24	D20
9	GB95	Flat washer	32	D12
10	GB5781	Hex Bolt	16	M12X35
11	GB93	Spring washer	16	D12
12	GB41	Hex nut	16	M12
13		Anchoring Bolt	16	φ19
14	TT7B-200-09A/B	Cover Plate	2*2	
15	GB93	Spring washer	24	D6
16	GB818	cross screw	16	M6X12
17	TT7B-200-10	Bushing	4	
18	GB78	Inner-hex bolt	4	M8X12
19	GB95	Flat washer	13	D24
20	TT7B-200-11	Spindle	4	
21	TT7B-200-08	Roller	10	
22	SF2518	Complex Bushing	10	
23	GB93	Spring washer		D6
24	GB818	Cross Bolt		M6X12
25	SGM-802-08	Orientination plate	8	
26	GB5781	Hex Bolt	32	M8X35
27	GB95	Flat washer	36	D8
28	TT7B-200-14	Nylon block	8	
29	GB95	Flat washer		D20
30	TT7B-200-06	Spindle	4	
31	TT7B-200-05	Rod	4	
32	TT7B-200-04	Safety block	4	
33	TT7B-200-07A/B	Torque spring	2*2	
34	GB6170	Hex Nut	8	M12
35	TT7B-200-02	busher	4	
36	TT7B-200-03-00A/B	Locking block	2*2	weldment
37	GB93	Spring washer	8	D8
38	GB6170	Hex nut	10	M8
39	TT7B-200-15	Spring	8	

Parts code for FP8K-DS

ITEM	CODE	DESCRIPTION	QTY	NOTE
40	TT7B-200-12-00	Spindle	4	weldment
41	TT7B-200-13	small roller	4	
42	DPF4-3.2-300-07-00	Plate	4	weldment
43	DPF4-3.2-300-06	Baffle plate	4	
44	GB5780	Hex Bolt	8	M18X100
45	GB93	Spring washer	8	D18
46	GB6170	Hex Nut	8	M18
47	GB95	Flat washer		D20
48	TT7B-300-01-04	Spindle bushing 4	2	
49	TT7B-300-01-05	Spindle	4	
50	TT7B-300-01-07	Spindle bushing 3	2	
51	TT7B-300-02-00	Main runway	1	weldment
52	TT7B-300-01-00	Sub runway	1	weldment
53	TT7B-500-04-00	approach ramp weldment	2	weldment
54	GB91	cotter pin	2	D5X60
55	DPF4-3.2-500-02	pin	1	
56		hydraulic cylinder	1	
57	DPF4-3.2-500-04	Plate	1	
58	DPF4-3.2-500-03	Block plate	1	
59	GB889	Nut	1	M24
60	GB95	Flat washer		D24
61	DPF4-3.2-600-00	Jack tray	1	weldment
62		Power unit	1	
63	GB5781	Hex Bolt	4	M8X25
64	GB95	Flat washer		D8
65	GB93	Spring washer		D8
66	GB6170	Hex Nut		M8
67	TT7B-200-01-00	Crossbeam	2	weldment
68	TT7B-500-02	Connecting pole	2	L=2080
69	TT7B-500-03	Anchoring bolt	2	
70	TT7B-500-01	Connecting pole	2	L=215
71		Knob	1	
72	DPF4-3.2-400-01-00	Handle	1	weldment
73	DPF4-3.2-400-04	Bushing	2	
74	DPF4-3.2-400-03	connection bush	2	
75	DPF4-3.2-400-11	Connecting pole	1	
76	DPF4-400-02-00	Connecting pole	1	weldment
77	GB889	Nut	8	M6
78	SI6TK	Bearing	8	M6
79	DPF4-3.2-400-09	Spacer	4	

Parts code for FP8K-DS

ITEM	CODE	DESCRIPTION	QTY	NOTE
80	GB96	Flat washer	4	D6
81	GB5781	Hex Bolt	4	M6X30
82	GB6170	Hex Nut	8	M6
83	TT7B-400-03	Angle fitting	1	
84	TT7B-400-04-00	Throttle Valve	1	
85	DPF4-3.2-500-10	Hydraulic Hose	1	
86	DPF4-3.2-500-07	Angle fitting	1	
87	GB95	Flat washer	1	d14
88	DPF4-3.2-500-06	Nut	1	
89	DPF4-3.2-500-11	Hydraulic hose	1	
90	TPF4-500-05	Tee fitting	1	
91	TPF4-500-09	Nut	2	
92	TPF4-500-08	washer	2	
93	TPF4-500-07	fitting	1	
94	TT7B-500-03A	Steel cable A	1	L=8175
95	TT7B-500-03B	Steel cable B	1	L=8750
96	TT7B-500-03D	Steel cable D	1	L=2710
97	TT7B-500-04C	Steel cable C	1	L=4130
98	GB95	Flat washer		D20
99	DPF4-500-12	Tight Nut	4	
100	GB5783	Galvanized Bolt	16	M10X35
101	GB93	Spring washer	16	D10
102	GB6170	Hex Nut	16	M10
103	GB95	Flat washer	16	D10
104	DPF4-3.2-700-01-00	Structure weldment	4	weldment
105	GB91	Cotter Pin	4	D4X50
106	DPF4-3.2-700-02-00	Pin	4	weldment
107		Caster	4	6"

IMPORTANT

POWER UNIT PRIMING PROCEDURE

THE PROBLEM: Power unit runs fine but will not pump any fluid.

Step 1 – Locate the check valve, the flush plug to the left of the lowering valve.
(See drawing below.)

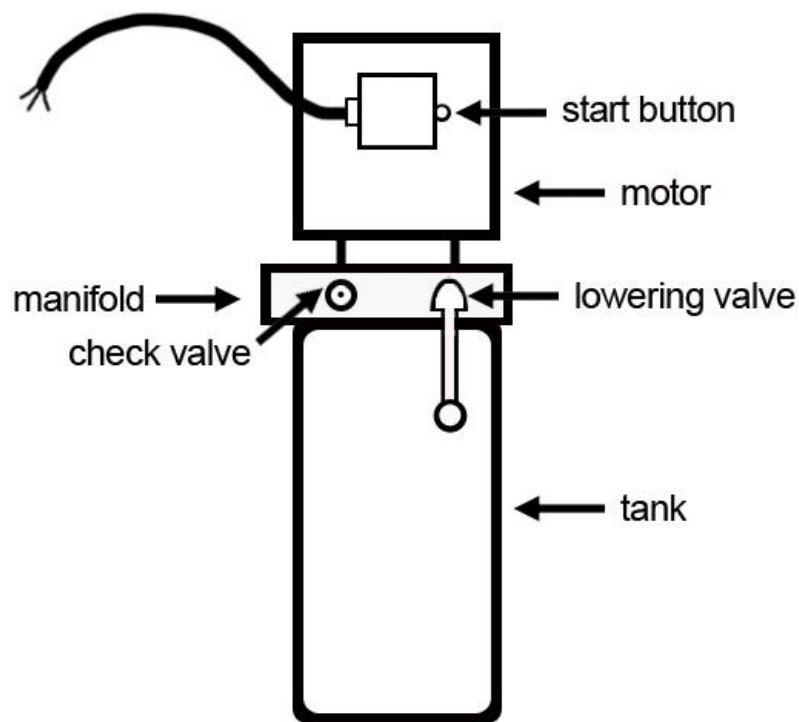

Step 2 – Using an Allen wrench and shop towel – with shop towel in place to catch fluid – loosen the check valve plug 2 ½ turns to allow it to leak.

Step 3 – Push the START button for one second, then release for three seconds.
Repeat these steps until unit starts pumping fluid.

Step 4 – Tighten the check valve plug.

YOUR POWER UNIT SHOULD BE PRIMED